



**LUX6M**



**LUX6MD**

**Novasub has developed a 6000 Lumen LED light, ideal for installations where much lighting is needed.**

Novasub LUX6M(D) LED light gives a high bright white flood light with daylight color temp. This flood light is ideal for a video camera and gives a suburb illumination. The light is housed in a rugged (duplex) stainless steel housing. Due to the use of LED's the lifetime is 50.000 hrs. Never change a bulb any more. The built in temp/power controller reduces the current to avoid any LED damage if the light is kept on outside water.

### Features

- **Small housing**
- **Extreme ruggedized**
- **Low power consumption**

### Applications

- **Fixed installations**
- **Drop down systems**
- **ROV systems**

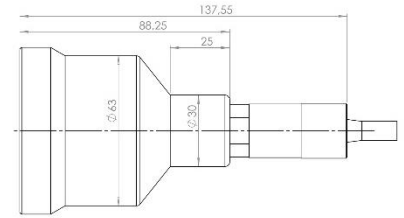
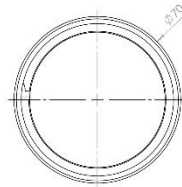

**LUX6M**

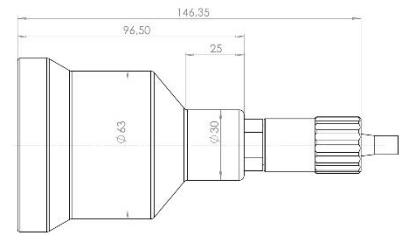
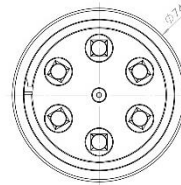

**LUX6MD**

### Specifications

	LUX6M	LUX6MD
Model		
Lumen @ 6500 K	6000	
Beam angle	120°	
Color Temp.	6500K	
LED's	6 x 8 w	
Operational depth	600 m	5000 m
Material	Stainless steel 316	Duplex stainless steel
Connector	MCBH2M, MCBH5M, MCBH4M & FAWL-BH4M	
Control	0-5 volt on Pin 3 and Pin 1	
	Direct 0-26 vdc or @ 26vdc 0-2,1 Ampere	
	rs485, 9600 bps, NovaBus control	
	rs485, 115k bps, NovaBus control	
Protection	Auto. Temp. Control, Polarity protection	
Power	26-48 vdc (55 watt)	
Dimensions	88,25 mm x ø 70 – ø 30 mm	96,5 mm x ø 74 – ø 30 mm
Weight	800 gr. (air), 700 gr. (water)	1020 gr. (air), 800 gr. (water)
Connection for mounting	Clamp	
Material options	Anodised Aluminum	Titanium
Front glass	Lexan	Sapphire

### Related Products:

- SCC-1VT1L6-DVR
- Novasub brackets
- NSBC
- DLR3 cable
- P&T-CL-01

### Distributed by: